



MEGADYNE



METAL DRIVE COMPONENTS

TECHNICAL
HANDBOOK

EN

PULEGGE PER CINGHIE DENTATE
TIMING BELT PULLEYS



PULEGGE DENTATE PER CINGHIE PASSO METRICO
TIMING BELT PULLEYS METRIC PITCH



ISTRUZIONI PER L'IDENTIFICAZIONE E LA CLASSIFICAZIONE DELLE PULEGGE A PASSO METRICO

INSTRUCTIONS FOR THE IDENTIFICATION AND CLASSIFICATION OF TIMING BELT PULLEYS METRIC PITCH

Esempio:
ALTEZZA 40 T 10/32-2

40 = Larghezza totale della puleggia 40 mm (L)
T10 = Passo 10 mm
30 = N. denti
2 = N. della flangia

Materiale:
alluminio 6082 T6
UNI 9006/4 adatto al trattamento anodico

Example:
PULLEY 40 T 10/32-2

40 = Total width of pulley 40 mm (L)
T10 = Pitch 10 mm
30 = No. of teeth
2 = No. of flanges

Material:
aluminium 6082 T6
UNI 9006/4 suitable for anodic treatment

Beispiel:
SCHEIBE 40 T 10/32-2

40 = Gesamtbreite der Scheibe 40 mm (L)
T10 = Teilung 10 mm
30 = Zähnezahl
2 = Anzahl der Bordscheiben

Werkstoff:
Aluminium 6082 T6
UNI 9006/4 geeignet für anodischen oxydation

Exemple:
POULIE 40 T 10/32-2

40 = Largeur totale de la poulie 40 mm (L)
T10 = Pas 10 mm
30 = N. de dents
2 = N. de flasques

Matière:
aluminium 6082 T6
UNI 9006/4 apte au traitement anodique

Ejemplo:
POLEA 40 T 10/32-2

40 = Ancho total de la polea 40 mm (L)
T10 = Paso 10 mm
30 = Cantidad de dientes
2 = Cantidad de tapetas

Material:
aluminio 6082 T6
UNI 9006/4 apto para la oxidación anódica

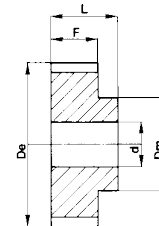
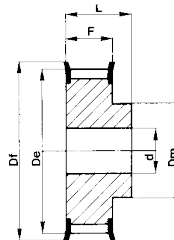
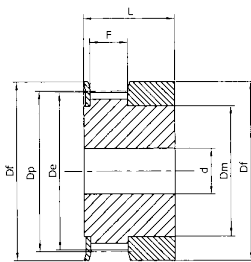

Materiale:
alluminio 6082 T6
UNI 9006/4 adatto al
trattamento anodico

Material:
aluminium 6082 T6
UNI 9006/4 suitable for
anodic treatment

Werkstoff:
Aluminium 6082 T6
UNI 9006/4 geeignet für
anodischen oxydation

Matière:
aluminium 6082 T6
UNI 9006/4 apte au
traitement anodique

Material:
aluminio 6082 T6
UNI 9006/4 apto para la
oxidacion anodica

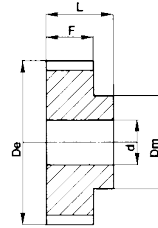
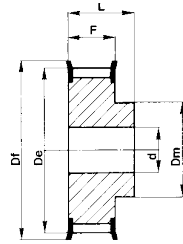

T 5

(Passo 5 mm) (Pitch 5 mm) (Teilung 5 mm) (Pas 5 mm) (Paso 5 mm)
per cinghia larghezza 16 mm for belt width 16 mm für Riemenbreite 16 mm pour courroies largeur 16 mm para correas ancho 16 mm

27T5/10-2	6F	FL003	10	15,92	15,05	19,5	8	21	27	4	0,016
27T5/12-2	6F	FL001	12	19,10	18,25	23,0	11	21	27	4	0,022
27T5/14-2	6F	FL002	14	22,29	21,45	25,0	13	21	27	4	0,026
27T5/15-2	6F	FL004	15	23,88	23,05	28,0	16	21	27	6	0,029
27T5/16-2	6F	FL005	16	25,47	24,60	32,0	18	21	27	6	0,035
27T5/18-2	6F	FL006	18	28,65	27,80	32,0	10	21	27	6	0,043
27T5/19-2	6F	FL008	19	30,25	29,40	36,0	20	21	27	6	0,049
27T5/20-2	6F	FL008	20	31,83	31,00	36,0	22	21	27	6	0,053
27T5/22-2	6F	FL009	22	35,02	34,15	38,0	23	21	27	6	0,065
27T5/24-2	6F	FL013	24	38,21	37,40	42,0	24	21	27	6	0,076
27T5/25-2	6F	FL012	25	39,80	38,95	44,0	26	21	27	6	0,078
27T5/26-2	6F	FL012	26	41,39	40,60	44,0	26	21	27	6	0,080
27T5/27-2	6F	FL011	27	42,98	42,20	48,0	30	21	27	8	0,090
27T5/28-2	6F	FL011	28	44,58	43,75	48,0	32	21	27	8	0,095
27T5/30-2	6F	FL016	30	47,76	46,95	51,0	34	21	27	8	0,105
27T5/32-2	6F	FL018	32	50,94	50,10	54,0	38	21	27	8	0,123
27T5/36-2	6F	FL023	36	57,31	56,45	64,0	38	21	27	8	0,160
27T5/40-2	6F	FL024	40	63,66	62,85	66,5	40	21	27	8	0,193
27T5/42-2	6F	FL026	42	66,86	66,00	70,0	40	21	27	8	0,200
27T5/44-0	6	-	44	70,05	69,20	-	45	21	27	8	0,300
27T5/48-0	6	-	48	76,42	75,55	-	50	21	27	8	0,280
27T5/60-0	6	-	60	95,52	94,65	-	65	21	27	8	0,430

(Passo 5 mm) (Pitch 5 mm) (Teilung 5 mm) (Pas 5 mm) (Paso 5 mm)
per cinghia larghezza 25 mm for belt width 25 mm für Riemenbreite 25 mm pour courroies largeur 25 mm para correas ancho 25 mm

36T5/10-2	6F	FL003	10	15,92	15,05	19,5	8	30	36	4	0,023
36T5/12-2	6F	FL001	12	19,10	18,25	23,0	11	30	36	4	0,031
36T5/14-2	6F	FL002	14	22,29	21,45	25,0	13	30	36	4	0,037
36T5/15-2	6F	FL004	15	23,88	23,05	28,0	16	30	36	6	0,041
36T5/16-2	6F	FL005	16	25,47	24,60	32,0	18	30	36	6	0,050
36T5/18-2	6F	FL006	18	28,65	27,80	32,0	10	30	36	6	0,061
36T5/19-2	6F	FL008	19	30,25	29,40	36,0	20	30	36	6	0,070
36T5/20-2	6F	FL008	20	31,83	31,00	36,0	22	30	36	6	0,076
36T5/22-2	6F	FL009	22	35,02	34,15	38,0	23	30	36	6	0,090
36T5/24-2	6F	FL013	24	38,21	37,40	42,0	24	30	36	8	0,109
36T5/25-2	6F	FL012	25	39,80	38,95	44,0	26	30	36	8	0,116
36T5/26-2	6F	FL012	26	41,39	40,60	44,0	26	30	36	8	0,100
36T5/27-2	6F	FL011	27	42,98	42,20	48,0	30	30	36	8	0,128
36T5/28-2	6F	FL011	28	44,58	43,75	48,0	32	30	36	8	0,135
36T5/30-2	6F	FL016	30	47,76	46,95	51,0	34	30	36	8	0,150
36T5/32-2	6F	FL018	32	50,94	50,10	54,0	38	30	36	8	0,176
36T5/36-2	6F	FL023	36	57,31	56,45	64,0	38	30	36	8	0,230
36T5/40-2	6F	FL024	40	63,66	62,85	66,5	40	30	36	8	0,276
36T5/42-2	6F	FL026	42	66,86	66,00	70,0	40	30	36	8	0,300
36T5/44-0	6	-	44	70,05	69,20	-	45	30	36	8	0,300
36T5/48-0	6	-	48	76,42	75,55	-	50	30	36	8	0,400
36T5/60-0	6	-	60	95,52	94,65	-	65	30	36	8	0,614

PULEGGE DENTATE PER CINGHIE PASSO METRICO TIMING BELT PULLEYS METRIC PITCH

Materiale:
alluminio 6082 T6
UNI 9006/4 adatto al
trattamento anodico

Material:
aluminium 6082 T6
UNI 9006/4 suitable for
anodic treatment

Werkstoff:
Aluminium 6082 T6
UNI 9006/4 geeignet für
anodischen oxydation

Matière:
aluminium 6082 T6
UNI 9006/4 apte au
traitement anodique

Material:
aluminio 6082 T6
UNI 9006/4 apto para la
oxidacion anodica

Tipo / Type
6F

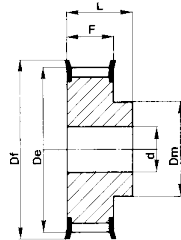

Tipo / Type
6

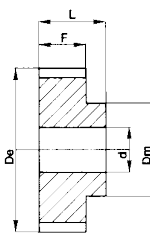

T 10

(Passo 10 mm)
per cinghia larghezza 16 mm

(Pitch 10 mm)
for belt width 16 mm

(Teilung 10 mm)
für Riemenbreite 16 mm

(Pas 10 mm)
pour courroies largeur 16 mm

(Paso 10 mm)
para correas ancho 16 mm

Descrizione / Description Beschreibung / Description Descripción	Tipo Type / Typ Type / Tipo	Codice flangia Flange code / Bordscheiben Typ Code flasque / Código brida	N. denti N. of teeth / Zähnezahl N. bre de dents Cantidad de dientes	Dp	De	Df	Dm	F	L	d	Peso / Weight Gewicht / Poids / Peso Kg
31T10/12-2	6F	FL013	12	38,20	36,35	42,0	28	21	31	6	0,076
31T10/14-2	6F	FL011	14	44,56	42,70	48,0	32	21	31	8	0,104
31T10/15-2	6F	FL016	15	47,75	45,90	51,0	32	21	31	8	0,116
31T10/16-2	6F	FL018	16	50,93	49,10	54,0	35	21	31	8	0,134
31T10/18-2	6F	FL021	18	57,29	55,45	60,0	40	21	31	8	0,167
31T10/19-2	6F	FL024	19	60,48	58,65	66,5	44	21	31	8	0,184
31T10/20-2	6F	FL024	20	63,66	61,80	66,5	46	21	31	8	0,208
31T10/22-2	6F	FL027	22	70,03	68,20	75,0	52	21	31	8	0,240
31T10/24-2	6F	FL029	24	76,39	74,55	83,0	58	21	31	8	0,288
31T10/25-2	6F	FL029	25	79,58	77,70	83,0	60	21	31	8	0,295
31T10/26-2	6F	FL031	26	82,76	80,90	87,0	60	21	31	8	0,310
31T10/27-2	6F	FL032	27	85,95	84,10	91,0	60	21	31	8	0,364
31T10/28-2	6F	FL033	28	89,12	87,25	93,0	60	21	31	8	0,441
31T10/30-2	6F	FL035	30	95,49	93,65	97,0	60	21	31	8	0,493
31T10/32-2	6F	FL038	32	101,86	100,00	106,0	65	21	31	10	0,623
31T10/36-2	6F	FL043	36	114,59	112,75	119,0	70	21	31	10	0,767
31T10/40-2	6F	FL047	40	127,32	125,45	131,0	80	21	31	10	0,950
31T10/44-0	6	-	44	140,05	138,20	-	88	21	31	10	1,090
31T10/48-0	6	-	48	152,78	150,95	-	95	21	31	16	1,704
31T10/60-0	6	-	60	190,98	189,10	-	110	21	31	16	1,704

(Passo 10 mm)
per cinghia larghezza 25 mm

(Pitch 10 mm)
for belt width 25 mm

(Teilung 10 mm)
für Riemenbreite 25 mm

(Pas 10 mm)
pour courroies largeur 25 mm

(Paso 10 mm)
para correas ancho 25 mm

Descrizione / Description Beschreibung / Description Descripción	Tipo Type / Typ Type / Tipo	Codice flangia Flange code / Bordscheiben Typ Code flasque / Código brida	N. denti N. of teeth / Zähnezahl N. bre de dents Cantidad de dientes	Dp	De	Df	Dm	F	L	d	Peso / Weight Gewicht / Poids / Peso Kg
40T10/12-2	6F	FL013	12	38,20	36,35	42,0	28	30	40	6	0,099
40T10/14-2	6F	FL011	14	44,56	42,70	48,0	32	30	40	8	0,134
40T10/15-2	6F	FL016	15	47,75	45,90	51,0	32	30	40	8	0,152
40T10/16-2	6F	FL018	16	50,93	49,10	54,0	35	30	40	8	0,176
40T10/18-2	6F	FL021	18	57,29	55,45	60,0	40	30	40	8	0,224
40T10/19-2	6F	FL024	19	60,48	58,65	66,5	44	30	40	8	0,247
40T10/20-2	6F	FL024	20	63,66	61,80	66,5	46	30	40	8	0,276
40T10/22-2	6F	FL027	22	70,03	68,20	75,0	52	30	40	8	0,310
40T10/24-2	6F	FL029	24	76,39	74,55	83,0	58	30	40	8	0,392
40T10/25-2	6F	FL029	25	79,58	77,70	83,0	60	30	40	8	0,422
40T10/26-2	6F	FL031	26	82,76	80,90	87,0	60	30	40	8	0,480
40T10/27-2	6F	FL032	27	85,95	84,10	91,0	60	30	40	8	0,536
40T10/28-2	6F	FL033	28	89,12	87,25	93,0	60	30	40	8	0,590
40T10/30-2	6F	FL035	30	95,49	93,65	97,0	60	30	40	8	0,640
40T10/32-2	6F	FL038	32	101,86	100,00	106,0	65	30	40	10	0,693
40T10/36-2	6F	FL043	36	114,59	112,75	119,0	70	30	40	10	0,873
40T10/40-2	6F	FL047	40	127,32	125,45	131,0	80	30	40	10	1,067
40T10/44-0	6	-	44	140,05	138,20	-	88	30	40	10	1,310
40T10/48-0	6	-	48	152,78	150,95	-	95	30	40	16	1,516
40T10/60-0	6	-	60	190,98	189,10	-	110	30	40	16	2,339

PULEGGE DENTATE PER CINGHIE PASSO METRICO TIMING BELT PULLEYS METRIC PITCH

Materiale:
alluminio 6082 T6
UNI 9006/4 adatto al
trattamento anodico

Material:
aluminium 6082 T6 UNI
9006/4 suitable for anodic
treatment

Werkstoff:
Aluminium 6082 T6
UNI 9006/4 geeignet für
anodischen oxydation

Matière:
aluminium 6082 T6
UNI 9006/4 apte au
traitement anodique

Material:
aluminio 6082 T6
UNI 9006/4 apto para la
oxidacion anodica

Tipo / Type
6F

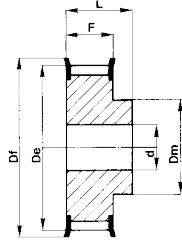

Tipo / Type
6

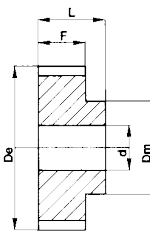

T 10

(Passo 10 mm)
per cinghia larghezza 32 mm

(Pitch 10 mm)
for belt width 32 mm

(Teilung 10 mm)
für Riemenbreite 32 mm

(Pas 10 mm)
pour courroies largeur 32 mm

(Paso 10 mm)
para correas ancho 32 mm

Descrizione / Description Beschreibung / Description Descripción	Tipo Type / Typ Type / Tipo	Codice flangia Flange code / Bordscheiben Typ Code flasque / Código brida	N. denti N. of teeth / Zähnezahl N. bre de dents Cantidad de dientes	Dp	De	Df	Dm	F	L	d	Peso / Weight Gewicht / Poids / Peso Kg
47T10/18-2	6F	FL021	18	57,29	55,45	60,0	40	37	47	10	0,253
47T10/19-2	6F	FL024	19	60,48	58,65	66,5	44	37	47	10	0,286
47T10/20-2	6F	FL024	20	63,66	61,80	66,5	46	37	47	12	0,322
47T10/22-2	6F	FL027	22	70,03	68,20	75,0	52	37	47	12	0,393
47T10/24-2	6F	FL029	24	76,39	74,55	83,0	58	37	47	12	0,475
47T10/25-2	6F	FL029	25	79,58	77,70	83,0	60	37	47	12	0,527
47T10/26-2	6F	FL031	26	82,76	80,90	87,0	60	37	47	12	0,564
47T10/27-2	6F	FL032	27	85,95	84,10	91,0	60	37	47	12	0,602
47T10/28-2	6F	FL033	28	89,12	87,25	93,0	60	37	47	12	0,642
47T10/30-2	6F	FL035	30	95,49	93,65	97,0	60	37	47	12	0,740
47T10/32-2	6F	FL038	32	101,86	100,00	106,0	65	37	47	12	0,844
47T10/36-2	6F	FL043	36	114,59	112,75	119,0	70	37	47	16	1,063
47T10/40-2	6F	FL047	40	127,32	125,45	131,0	80	37	47	16	1,371
47T10/44-0	6	-	44	140,05	138,20	-	88	37	47	16	1,611
47T10/48-0	6	-	48	152,78	150,95	-	95	37	47	16	1,913
47T10/60-0	6	-	60	190,98	189,10	-	110	37	47	16	3,004

(Passo 10 mm)
per cinghia larghezza 50 mm

(Pitch 10 mm)
for belt width 50 mm

(Teilung 10 mm)
für Riemenbreite 50 mm

(Pas 10 mm)
pour courroies largeur 50 mm

(Paso 10 mm)
para correas ancho 50 mm

66T10/18-2	6F	FL021	18	57,29	55,45	60,0	40	56	66	10	0,422
66T10/19-2	6F	FL024	19	60,48	58,65	66,5	44	56	66	10	0,466
66T10/20-2	6F	FL024	20	63,66	61,80	66,5	46	56	66	12	0,520
66T10/22-2	6F	FL027	22	70,03	68,20	75,0	52	56	66	12	0,640
66T10/24-2	6F	FL029	24	76,39	74,55	83,0	58	56	66	12	0,736
66T10/25-2	6F	FL029	25	79,58	77,70	83,0	60	56	66	12	0,766
66T10/26-2	6F	FL031	26	82,76	80,90	87,0	60	56	66	12	0,845
66T10/27-2	6F	FL032	27	85,95	84,10	91,0	60	56	66	12	0,946
66T10/28-2	6F	FL033	28	89,12	87,25	93,0	60	56	66	12	0,110
66T10/30-2	6F	FL035	30	95,49	93,65	97,0	60	56	66	12	1,169
66T10/32-2	6F	FL038	32	101,86	100,00	106,0	65	56	66	12	1,300
66T10/36-2	6F	FL043	36	114,59	112,75	119,0	70	56	66	16	1,637
66T10/40-2	6F	FL047	40	127,32	125,45	131,0	80	56	66	16	1,999
66T10/44-0	6	-	44	140,05	138,20	-	88	56	66	16	2,420
66T10/48-0	6	-	48	152,78	150,95	-	95	56	66	16	2,830
66T10/60-0	6	-	60	190,98	189,10	-	110	56	66	16	4,366

PULEGGE DENTATE PER CINGHIE PASSO METRICO TIMING BELT PULLEYS METRIC PITCH

Materiale:
Ghisa

Material:
Cast iron

Werkstoff:
Grauguss

Matière:
Fonte

Material:
Hierro fundido

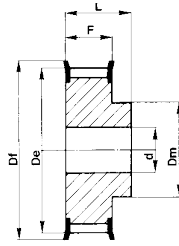

Tipo / Type
6F

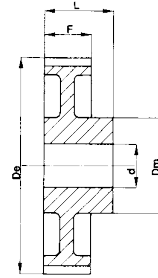

Tipo / Type
6W

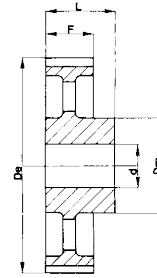

Tipo / Type
6A

T 20

(Passo 20 mm)
per cinghia larghezza 32 mm

(Pitch 20 mm)
for belt width 32 mm

(Teilung 20 mm)
für Riemenbreite 32 mm

(Pas 20 mm)
pour courroies largeur 32 mm

(Paso 20 mm)
para correas ancho 32 mm

Descrizione / Description Beschreibung / Description Descripción	Tipo Type / Typ Type / Tipo	Codice flangia Flange code / Bordscheiben Typ Code flasque / Código brida	N. denti N. of teeth / Zähnezahl N. bre de dents Cantidad de dientes	De	Df	Dm	F	L	d	Peso / Weight Gewicht / Poids / Peso Kg
53T20/18-2	6F	FL075	18	111,75	120,0	80	38	53	15	
53T20/20-2	6F	FL080	20	124,50	135,0	90	38	53	15	
53T20/22-2	6F	FL085	22	137,20	150,0	90	38	53	15	
53T20/24-2	6F	FL086	24	149,95	158,0	95	38	53	15	
53T20/25-2	6F	FL090	25	156,30	168,0	95	38	53	15	
53T20/30-2	6F	FL100	30	188,15	200,0	110	38	53	15	
53T20/32-2	6W	-	32	200,85	-	110	38	53	18	
53T20/36-2	6W	-	36	226,35	-	110	38	53	18	
53T20/40-2	6A	-	40	251,80	-	110	38	53	20	
53T20/48-2	6A	-	48	302,70	-	130	38	53	20	
53T20/60-2	6A	-	60	379,10	-	130	38	53	20	
53T20/72-2	6A	-	72	455,50	-	140	38	53	20	

(Passo 20 mm)
per cinghia larghezza 50 mm

(Pitch 20 mm)
for belt width 50 mm

(Teilung 20 mm)
für Riemenbreite 50 mm

(Pas 20 mm)
pour courroies largeur 50 mm

(Paso 20 mm)
para correas ancho 50 mm

71T20/18-2	6F	FL075	18	111,75	120,0	80	56	71	18	
71T20/20-2	6F	FL080	20	124,50	135,0	90	56	71	18	
71T20/22-2	6F	FL085	22	137,20	150,0	90	56	71	18	
71T20/24-2	6F	FL086	24	149,95	158,0	95	56	71	18	
71T20/25-2	6F	FL090	25	156,30	168,0	95	56	71	18	
71T20/30-2	6F	FL100	30	188,15	200,0	110	56	71	18	
71T20/32-2	6W	-	32	200,85	-	110	56	71	20	
71T20/36-2	6W	-	36	226,35	-	110	56	71	20	
71T20/40-2	6A	-	40	251,80	-	110	56	71	20	
71T20/48-2	6A	-	48	302,70	-	130	56	71	24	
71T20/60-2	6A	-	60	379,10	-	130	56	71	24	
71T20/72-2	6A	-	72	455,50	-	140	56	71	24	

(Passo 20 mm)
per cinghia larghezza 100 mm

(Pitch 20 mm)
for belt width 100 mm

(Teilung 20 mm)
für Riemenbreite 100 mm

(Pas 20 mm)
pour courroies largeur 100 mm

(Paso 20 mm)
para correas ancho 100 mm

123T20/18-2	6F	FL075	18	111,75	120,0	80	108	123	24	
123T20/20-2	6F	FL080	20	124,50	135,0	90	108	123	24	
123T20/22-2	6F	FL085	22	137,20	150,0	90	108	123	24	
123T20/24-2	6F	FL086	24	149,95	158,0	95	108	123	24	
123T20/25-2	6F	FL090	25	156,30	168,0	95	108	123	24	
123T20/30-2	6F	FL100	30	188,15	200,0	110	108	123	24	
123T20/32-2	6W	-	32	200,85	-	110	108	123	32	
123T20/36-2	6W	-	36	226,35	-	110	108	123	32	
123T20/40-2	6A	-	40	251,80	-	110	108	123	32	
123T20/48-2	6A	-	48	302,70	-	130	108	123	32	
123T20/60-2	6A	-	60	379,10	-	130	108	123	32	
123T20/72-2	6A	-	72	455,50	-	140	108	123	32	

BARRE DENTATE STANDARD STANDARD TOOTHED BARS

Materiale:
alluminio 6082 T6
UNI 9006/4 adatto al
trattamento anodico

Material:
aluminium 6082 T6
UNI 9006/4 suitable for
anodic treatment

Werkstoff:
Aluminium 6082 T6
UNI 9006/4 geeignet für
anodischen oxydation

Matière:
aluminium 6082 T6
UNI 9006/4 apte au
traitement anodique

Material:
aluminio 6082 T6
UNI 9006/4 apto para la
oxidacion anodica

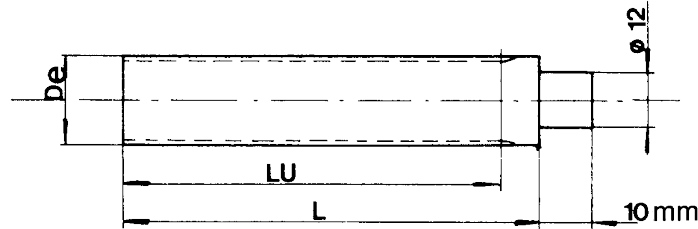

T 2,5

(Passo 2,5 mm) / (Pitch 2,5 mm) / (Teilung 2,5 mm)
(Pas 2,5 mm) / (Paso 2,5 mm)

Descrizione Description Beschreibung Description Descripción	N. denti N. of teeth / Zähnezahl N. bre de dents Cantidad de dientes	De	Lu	L
T2,5-10	10	7,42	50	75
T2,5-12	12	9,00	50	75
T2,5-13	13	9,80	50	75
T2,5-14	14	10,60	50	75
T2,5-15	15	11,40	50	75
T2,5-16	16	12,20	50	75
T2,5-17	17	13,00	50	75
T2,5-18	18	13,80	50	75
T2,5-19	19	14,60	90	120
T2,5-20	20	15,40	90	120
T2,5-21	21	16,20	90	120
T2,5-22	22	17,00	125	140
T2,5-24	24	18,55	125	140
T2,5-26	26	20,15	125	140
T2,5-27	27	20,95	125	140
T2,5-28	28	21,75	125	140
T2,5-29	29	22,55	125	140
T2,5-30	30	23,35	125	140
T2,5-32	32	24,95	125	140
T2,5-34	34	26,55	125	140
T2,5-35	35	27,35	132	140
T2,5-36	36	28,10	132	140
T2,5-38	38	29,70	132	140
T2,5-40	40	31,30	132	140
T2,5-42	42	32,90	140	140
T2,5-44	44	34,50	140	140
T2,5-45	45	35,30	140	140
T2,5-48	48	37,70	140	140
T2,5-50	50	39,29	160	160
T2,5-60	60	47,25	160	160
T2,5-65	65	51,20	160	160
T2,5-70	70	55,20	160	160
T2,5-72	72	56,80	160	160
T2,5-90	90	71,12	160	160
T2,5-100	100	79,08	160	160

T 5

(Passo 5 mm) / (Pitch 5 mm) / (Teilung 5 mm)
(Pas 5 mm) / (Paso 5 mm)

Descrizione Description Beschreibung Description Descripción	N. denti N. of teeth / Zähnezahl N. bre de dents Cantidad de dientes	De	Lu	L
T5-10	10	15,05	125	140
T5-11	11	16,65	125	140
T5-12	12	18,25	125	140
T5-13	13	19,85	125	140
T5-14	14	21,45	132	140
T5-15	15	23,05	132	140
T5-16	16	24,60	140	140
T5-17	17	26,20	140	140
T5-18	18	27,80	140	140
T5-19	19	29,40	140	140
T5-20	20	31,00	160	160
T5-21	21	32,70	160	160
T5-22	22	34,15	160	160
T5-23	23	35,85	160	160
T5-24	24	37,40	160	160
T5-25	25	38,95	160	160
T5-26	26	40,60	160	160
T5-27	27	42,20	160	160
T5-28	28	43,75	160	160
T5-29	29	45,35	160	160
T5-30	30	46,95	160	160
T5-32	32	50,10	160	160
T5-34	34	53,25	160	160
T5-35	35	54,85	160	160
T5-36	36	56,45	160	160
T5-37	37	58,06	160	160
T5-38	38	59,65	160	160
T5-40	40	62,85	160	160
T5-42	42	66,00	160	160
T5-44	44	69,20	160	160
T5-45	45	70,80	160	160
T5-46	46	72,40	160	160
T5-48	48	75,55	160	160
T5-50	50	78,75	160	160
T5-60	60	94,65	160	160
T5-72	72	113,75	160	160
T5-80	80	126,48	160	160
T5-90	90	142,40	160	160
T5-100	100	158,31	160	160

T 10

(Passo 10 mm) / (Pitch 10 mm) / (Teilung 10 mm)
(Pas 10 mm) / (Paso 10 mm)

Per barre con n. di denti non
inclusi in queste tavole, chiedete
per quotazione.

For bars with a number of teeth
not included in these tables
please ask for our quotation.

Verlangen sie Angebot für
Stangen mit anzahl von Zaehnen
die nicht in diesen Tafeln
aufgefuehrt sind.

Pour les barreaux avec un
nombre de dents different du
tableau, nous consulter.

Pidan oferta por lo que
concierna una cantidad de
dientes no incluida en estas
tablas.

**PULEGGE PER CINGHIE DENTATE
PASSO METRICO ST PER CINGHIE «AT»
ST TIMING BELT PULLEYS METRIC PITCH FOR «AT» BELTS**



PULEGGE PER CINGHIE DENTATE PASSO METRICO ST PER CINGHIE «AT» ST TIMING BELT PULLEYS METRIC PITCH FOR «AT» BELTS

Materiale:
alluminio 6082 T6
UNI 9006/4 adatto al
trattamento anodico

Material:
aluminium 6082 T6
UNI 9006/4 suitable for
anodic treatment

Werkstoff:
Aluminium 6082 T6
UNI 9006/4 geeignet für
anodischen oxydation

Matière:
aluminium 6082 T6
UNI 9006/4 apte au
traitement anodique

Material:
aluminio 6082 T6
UNI 9006/4 apto para la
oxidacion anodica

Tipo / Type
6F

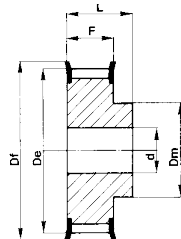

Tipo / Type
6

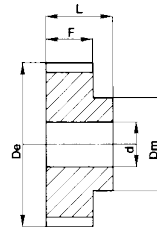

ST 10

(Passo 10 mm)
per cinghia larghezza 16 mm

(Pitch 10 mm)
for belt width 16 mm

(Teilung 10 mm)
für Riemenbreite 16 mm

(Pas 10 mm)
pour courroies largeur 16 mm

(Paso 10 mm)
para correas ancho 16 mm

Descrizione / Description Beschreibung / Description Descripción	Tipo Type / Typ Type / Tipo	Codice flangia Flange code / Bordscheiben Typ Code flasque / Código brida	N. denti N. of teeth / Zähnezahl N. bre de dents Cantidad de dientes	Dp	De	Df	Dm	F	L	d	Peso / Weight Gewicht / Poids / Peso Kg
31 ST10/15-2	6F	FL016	15	47,75	45,90	51,0	31	21	31	8	0,118
31 ST10/16-2	6F	FL018	16	50,93	49,05	54,0	35	21	31	8	0,134
31 ST10/18-2	6F	FL021	18	57,29	55,45	60,0	40	21	31	8	0,167
31 ST10/19-2	6F	FL024	19	60,48	58,60	66,5	44	21	31	8	0,184
31 ST10/20-2	6F	FL024	20	63,66	61,80	66,5	46	21	31	8	0,208
31 ST10/22-2	6F	FL027	22	70,03	68,15	75,0	52	21	31	8	0,253
31 ST10/24-2	6F	FL029	24	76,39	74,55	83,0	58	21	31	8	0,288
31 ST10/25-2	6F	FL029	25	79,58	77,70	83,0	60	21	31	8	0,310
31 ST10/26-2	6F	FL031	26	82,76	80,90	87,0	60	21	31	8	0,357
31 ST10/27-2	6F	FL032	27	85,95	84,10	91,0	60	21	31	8	0,364
31 ST10/28-2	6F	FL033	28	89,12	87,25	93,0	60	21	31	8	0,401
31 ST10/30-2	6F	FL035	30	95,49	93,65	97,0	60	21	31	8	0,441
31 ST10/32-2	6F	FL038	32	101,86	100,00	106,0	65	21	31	10	0,493
31 ST10/36-2	6F	FL043	36	114,59	112,75	119,0	70	21	31	10	0,623
31 ST10/40-2	6F	FL047	40	127,32	125,45	131,0	80	21	31	10	0,787
31 ST10/44-0	6	-	44	140,05	138,20	-	88	21	31	10	0,993
31 ST10/48-0	6	-	48	152,78	150,95	-	95	21	31	16	1,090
31 ST10/60-0	6	-	60	190,98	189,10	-	110	21	31	16	1,701

(Passo 10 mm)
per cinghia larghezza 25 mm

(Pitch 10 mm)
for belt width 25 mm

(Teilung 10 mm)
für Riemenbreite 25 mm

(Pas 10 mm)
pour courroies largeur 25 mm

(Paso 10 mm)
para correas ancho 25 mm

40 ST10/15-2	6F	FL016	15	47,75	45,90	51,0	31	30	40	8	0,152
40 ST10/16-2	6F	FL018	16	50,93	49,05	54,0	35	30	40	8	0,176
40 ST10/18-2	6F	FL021	18	57,29	55,45	60,0	40	30	40	8	0,224
40 ST10/19-2	6F	FL024	19	60,48	58,60	66,5	44	30	40	8	0,247
40 ST10/20-2	6F	FL024	20	63,66	61,80	66,5	46	30	40	8	0,276
40 ST10/22-2	6F	FL027	22	70,03	68,15	75,0	52	30	40	8	0,337
40 ST10/24-2	6F	FL029	24	76,39	74,55	83,0	58	30	40	8	0,392
40 ST10/25-2	6F	FL029	25	79,58	77,70	83,0	60	30	40	8	0,422
40 ST10/26-2	6F	FL031	26	82,76	80,90	87,0	60	30	40	8	0,477
40 ST10/27-2	6F	FL032	27	85,95	84,10	91,0	60	30	40	8	0,536
40 ST10/28-2	6F	FL033	28	89,12	87,25	93,0	60	30	40	8	0,540
40 ST10/30-2	6F	FL035	30	95,49	93,65	97,0	60	30	40	8	0,640
40 ST10/32-2	6F	FL038	32	101,86	100,00	106,0	65	30	40	10	0,693
40 ST10/36-2	6F	FL043	36	114,59	112,75	119,0	70	30	40	10	0,873
40 ST10/40-2	6F	FL047	40	127,32	125,45	131,0	80	30	40	10	1,067
40 ST10/44-0	6	-	44	140,05	138,20	-	88	30	40	10	1,350
40 ST10/48-0	6	-	48	152,78	150,95	-	95	30	40	16	1,516
40 ST10/60-0	6	-	60	190,98	189,10	-	110	30	40	16	2,339

PULEGGE PER CINGHIE DENTATE PASSO METRICO ST PER CINGHIE «AT» ST TIMING BELT PULLEYS METRIC PITCH FOR «AT» BELTS

Materiale:
alluminio 6082 T6
UNI 9006/4 adatto al
trattamento anodico

Material:
aluminium 6082 T6
UNI 9006/4 suitable for
anodic treatment

Werkstoff:
Aluminium 6082 T6
UNI 9006/4 geeignet für
anodischen oxydation

Matière:
aluminium 6082 T6
UNI 9006/4 apte au
traitement anodique

Material:
aluminio 6082 T6
UNI 9006/4 apto para la
oxidacion anodica

Tipo / Type
6F

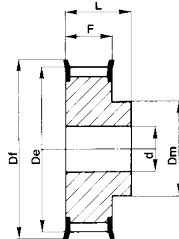

Tipo / Type
6

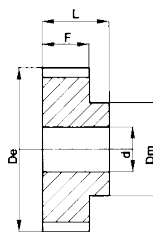

ST 10

(Passo 10 mm)
per cinghia larghezza 32 mm

(Pitch 10 mm)
for belt width 32 mm

(Teilung 10 mm)
für Riemenbreite 32 mm

(Pas 10 mm)
pour courroies largeur 32 mm

(Paso 10 mm)
para correas ancho 32 mm

Descrizione / Description Beschreibung / Description Descripción	Tipo Type / Typ Type / Tipo	Codice flangia Flange code / Bordscheiben Typ Code flasque / Código brida	N. denti N. of teeth / Zahnzahl N. bre de dents Cantidad de dientes	Dp	De	Df	Dm	F	L	d	Peso / Weight Gewicht / Poids / Peso Kg
47 ST10/18-2	6F	FL021	18	57,29	55,45	60,0	40	37	47	10	0,253
47 ST10/19-2	6F	FL024	19	60,48	58,60	66,5	44	37	47	10	0,286
47 ST10/20-2	6F	FL024	20	63,66	61,80	66,5	46	37	47	12	0,322
47 ST10/22-2	6F	FL027	22	70,03	68,15	75,0	52	37	47	12	0,393
47 ST10/24-2	6F	FL029	24	76,39	74,55	83,0	58	37	47	12	0,475
47 ST10/25-2	6F	FL029	25	79,58	77,70	83,0	60	37	47	12	0,527
47 ST10/26-2	6F	FL031	26	82,76	80,90	87,0	60	37	47	12	0,564
47 ST10/27-2	6F	FL032	27	85,95	84,10	91,0	60	37	47	12	0,602
47 ST10/28-2	6F	FL033	28	89,12	87,25	93,0	60	37	47	12	0,642
47 ST10/30-2	6F	FL035	30	95,49	93,65	97,0	60	37	47	12	0,740
47 ST10/32-2	6F	FL038	32	101,86	100,00	106,0	65	37	47	12	0,844
47 ST10/36-2	6F	FL043	36	114,59	112,75	119,0	70	37	47	16	1,063
47 ST10/40-2	6F	FL047	40	127,32	125,45	131,0	80	37	47	16	1,317
47 ST10/44-0	6	-	44	140,05	138,20	-	88	37	47	16	1,611
47 ST10/48-0	6	-	48	152,78	150,95	-	95	37	47	16	1,931
47 ST10/60-0	6	-	60	190,98	189,10	-	110	37	47	16	3,004

(Passo 10 mm)
per cinghia larghezza 50 mm

(Pitch 10 mm)
for belt width 50 mm

(Teilung 10 mm)
für Riemenbreite 50 mm

(Pas 10 mm)
pour courroies largeur 50 mm

(Paso 10 mm)
para correas ancho 50 mm

66 ST10/18-2	6F	FL021	18	57,29	55,45	60,0	40	56	66	10	0,422
66 ST10/19-2	6F	FL024	19	60,48	58,60	66,5	44	56	66	10	0,466
66 ST10/20-2	6F	FL024	20	63,66	61,80	66,5	46	56	66	12	0,520
66 ST10/22-2	6F	FL027	22	70,03	68,15	75,0	52	56	66	12	0,570
66 ST10/24-2	6F	FL029	24	76,39	74,55	83,0	58	56	66	12	0,736
66 ST10/25-2	6F	FL029	25	79,58	77,70	83,0	60	56	66	12	0,766
66 ST10/26-2	6F	FL031	26	82,76	80,90	87,0	60	56	66	12	0,816
66 ST10/27-2	6F	FL032	27	85,95	84,10	91,0	60	56	66	12	0,946
66 ST10/28-2	6F	FL033	28	89,12	87,25	93,0	60	56	66	12	0,960
66 ST10/30-2	6F	FL035	30	95,49	93,65	97,0	60	56	66	12	1,169
66 ST10/32-2	6F	FL038	32	101,86	100,00	106,0	65	56	66	12	1,300
66 ST10/36-2	6F	FL043	36	114,59	112,75	119,0	70	56	66	16	1,637
66 ST10/40-2	6F	FL047	40	127,32	125,45	131,0	80	56	66	16	1,999
66 ST10/44-0	6	-	44	140,05	138,20	-	88	56	66	16	2,357
66 ST10/48-0	6	-	48	152,78	150,95	-	95	56	66	16	2,830
66 ST10/60-0	6	-	60	190,98	189,10	-	110	56	66	16	4,368

BARRE DENTATE STANDARD ST PER CINGHIE “ AT ” ST STANDARD TOOTHED BARS FOR “ AT ” BELTS

Materiale:
alluminio 6082 T6
UNI 9006/4 adatto al
trattamento anodico

Material:
aluminium 6082 T6
UNI 9006/4 suitable for
anodic treatment

Werkstoff:
aluminium 6082 T6
UNI 9006/4 geeignet für
anodischen oxydation

Matière:
aluminium 6082 T6
UNI 9006/4 apte au
traitement anodique

Material:
aluminio 6082 T6
UNI 9006/4 apto para la
oxidacion anodica

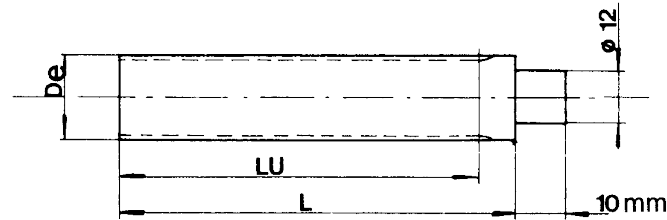

ST 5

(Passo 5 mm) / (Pitch 5 mm) / (Teilung 5 mm) / (Pas 5 mm) / (Paso 5 mm)

Descrizione Description Beschreibung Descripción	N. denti N. of teeth / Zähnezahl / N. bre de dents Cantidad de dientes	De	Lu	L
ST05012	12	17,85	125	140
ST05013	13	19,45	125	140
ST05014	14	21,05	132	140
ST05015	15	22,65	132	140
ST05016	16	24,20	140	140
ST05017	17	25,80	140	140
ST05018	18	27,40	140	140
ST05019	19	29,00	140	140
ST05020	20	30,60	160	160
ST05021	21	32,30	160	160
ST05022	22	33,85	160	160
ST05023	23	35,45	160	160
ST05024	24	37,00	160	160
ST05025	25	38,60	160	160
ST05026	26	40,20	160	160
ST05027	27	41,80	160	160
ST05028	28	43,35	160	160
ST05029	29	44,95	160	160
ST05030	30	46,55	160	160
ST05031	31	48,15	160	160
ST05032	32	49,70	160	160
ST05033	33	51,30	160	160
ST05034	34	52,85	160	160
ST05035	35	54,45	160	160
ST05036	36	56,05	160	160
ST05038	38	59,25	160	160
ST05040	40	62,45	160	160
ST05042	42	65,60	160	160
ST05044	44	68,80	160	160
ST05045	45	70,40	160	160
ST05046	46	72,00	160	160
ST05048	48	75,15	160	160
ST05050	50	78,35	160	160
ST05052	52	81,55	160	160
ST05054	54	84,70	160	160
ST05055	55	86,30	160	160
ST05056	56	87,90	160	160
ST05058	58	91,10	160	160
ST05060	60	94,25	160	160
ST05062	62	97,45	160	160
ST05064	64	100,65	160	160
ST05065	65	102,25	160	160
ST05070	70	110,20	160	160
ST05072	72	113,25	160	160

ST 10

(Passo 10 mm) / (Pitch 10 mm) / (Teilung 10 mm) / (Pas 10 mm) / (Paso 10 mm)

Codice Code symbol Bezeichnung Code symbole Numero de fabrica	N. denti N. of teeth / Zähnezahl / N. bre de dents Cantidad de dientes	De	Lu	L
ST10015	15	45,90	160	160
ST10016	16	49,05	160	160
ST10017	17	52,25	160	160
ST10018	18	55,45	160	160
ST10019	19	58,60	160	160
ST10020	20	61,80	160	160
ST10021	21	65,00	160	160
ST10022	22	68,15	160	160
ST10023	23	71,35	160	160
ST10024	24	74,55	160	160
ST10025	25	77,70	160	160
ST10026	26	80,90	160	160
ST10027	27	84,10	160	160
ST10028	28	87,25	160	160
ST10029	29	90,45	160	160
ST10030	30	93,65	160	160
ST10031	31	96,80	160	160
ST10032	32	100,00	160	160
ST10033	33	103,20	160	160
ST10034	34	106,40	160	160
ST10035	35	109,55	160	160
ST10036	36	112,75	160	160
ST10037	37	115,90	160	160
ST10038	38	119,10	160	160
ST10040	40	125,45	160	160
ST10041	41	128,65	160	160
ST10042	42	131,85	160	160
ST10044	44	138,20	160	160
ST10045	45	141,40	160	160
ST48046	46	144,55	160	160
ST10048	48	150,95	160	160
ST10050	50	157,30	160	160
ST10051	51	160,50	160	160
ST10052	52	163,65	160	160
ST10054	54	170,05	160	160
ST10055	55	173,20	160	160
ST10056	56	176,40	160	160
ST10057	57	179,60	160	160
ST10058	58	182,75	160	160
ST10059	59	185,95	160	160
ST10060	60	189,10	160	160
ST10062	62	195,50	160	160
ST10070	70	220,95	160	160
ST10075	75	236,90	160	160

Discover Your Local Contacts

The local partner of choice
for sustainable power transmission belting solutions
around the globe.



General contact information:

Megadyne

Via Trieste, 16

Via S. Lucia 114 - 10075 Mathi (Torino)

Italy

megadynegroup.com

megadynegroup.com/en/contact-us



Scan the QR code
and find your local
contact

